

**Door Label:**  
 First part stands for door width and second part stands for door height.

Example: 21068  
 2'-10"=width  
 6'-8"=Height

**\*\*For Interior Door RO Rules:\*\***  
 Add 2-1/2" inches to width for RO  
 Add 2-1/2" inches to height for RO

**Common Door RO:**

Door Label	Width	Height
6068	6'-2 1/2"	6'-10 1/2"
5068	5'-2 1/2"	6'-10 1/2"
4068	4'-2 1/2"	6'-10 1/2"
3068	3'-2 1/2"	6'-10 1/2"
21068	3'-0 1/2"	6'-10 1/2"
2668	2'-8 1/2"	6'-10 1/2"
2468	2'-6 1/2"	6'-10 1/2"
2268	2'-4 1/2"	6'-10 1/2"
2068	2'-2 1/2"	6'-10 1/2"
11068	2'-0 1/2"	6'-10 1/2"
1868	1'-10 1/2"	6'-10 1/2"
1668	1'-8 1/2"	6'-10 1/2"
1468	1'-6 1/2"	6'-10 1/2"
1268	1'-4 1/2"	6'-10 1/2"

**Exterior Door RO's:**  
 Defer to exterior door order packet.  
 Different RO's depending on brand (Andersen, MB, Thematru etc.)

**1st Floor Finished Living - 1,811 S/F**  
**2nd Floor Finished Storage - 389 S/F**  
**Total Living Area - 2,200 S/F**  
**Garage - 807 S/F**

Window Label	Name	Window Type	RO Width (Ft. & In.)	RO Height (Ft. & In.)	RO Width (Inches)	RO Height (Inches)	Brand	Notes
A	(2)244DH2860	(2) Double Hung	5' 4"	6' 0"	64	72	Andersen	
B	AXW2281	Double Awning	5' 3 1/4"	3' 0 1/2"	63 1/4	36 1/2	Andersen	
C	(3)244DH2860	(3)Double Hung	8' 0"	6' 0"	96	72	Andersen	
D	(3)244DH3060	(3)Double Hung	9' 0"	6' 0"	108	72	Andersen	
E	(2)FX3010	Fixed	6' 0"	1' 0"	72	12	Andersen	
F	244DH3060	Double Hung	3' 0"	6' 0"	36	72	Andersen	
G	AXW331	Triple Awning	9' 0 5/8"	3' 0 1/2"	108 5/8	36 1/2	Andersen	
H	(2)244DH3060	(2) Double Hung	6' 0"	6' 0"	72	72	Andersen	
J	AXW31	Awning	3' 0 1/2"	3' 0 1/2"	36 1/2	3' 0 1/2"	Andersen	
K	AXW231	Double Awning	6' 0 1/8"	3' 0 1/2"	72 1/8	36 1/2	Andersen	
L	CW14	Fixed Casement	2' 4 7/8"	4' 0 1/2"	28 7/8	48 1/2	Andersen	Fixed
M	244DH3050	Double Hung	3' 0"	5' 0"	36	60	Andersen	

NO.	DESCRIPTION	BY	DATE

SHEET TITLE:  
**First Floor**

PROJECT DESCRIPTION:  
**HG-278 - Infill Site # 1**  
**Plan-1336.04-Rev 3**

DRAWINGS PROVIDED BY:

DATE:  
**2/15/24**

SCALE:  
**1/4"=1'-0"**

SHEET:  
**A-1**

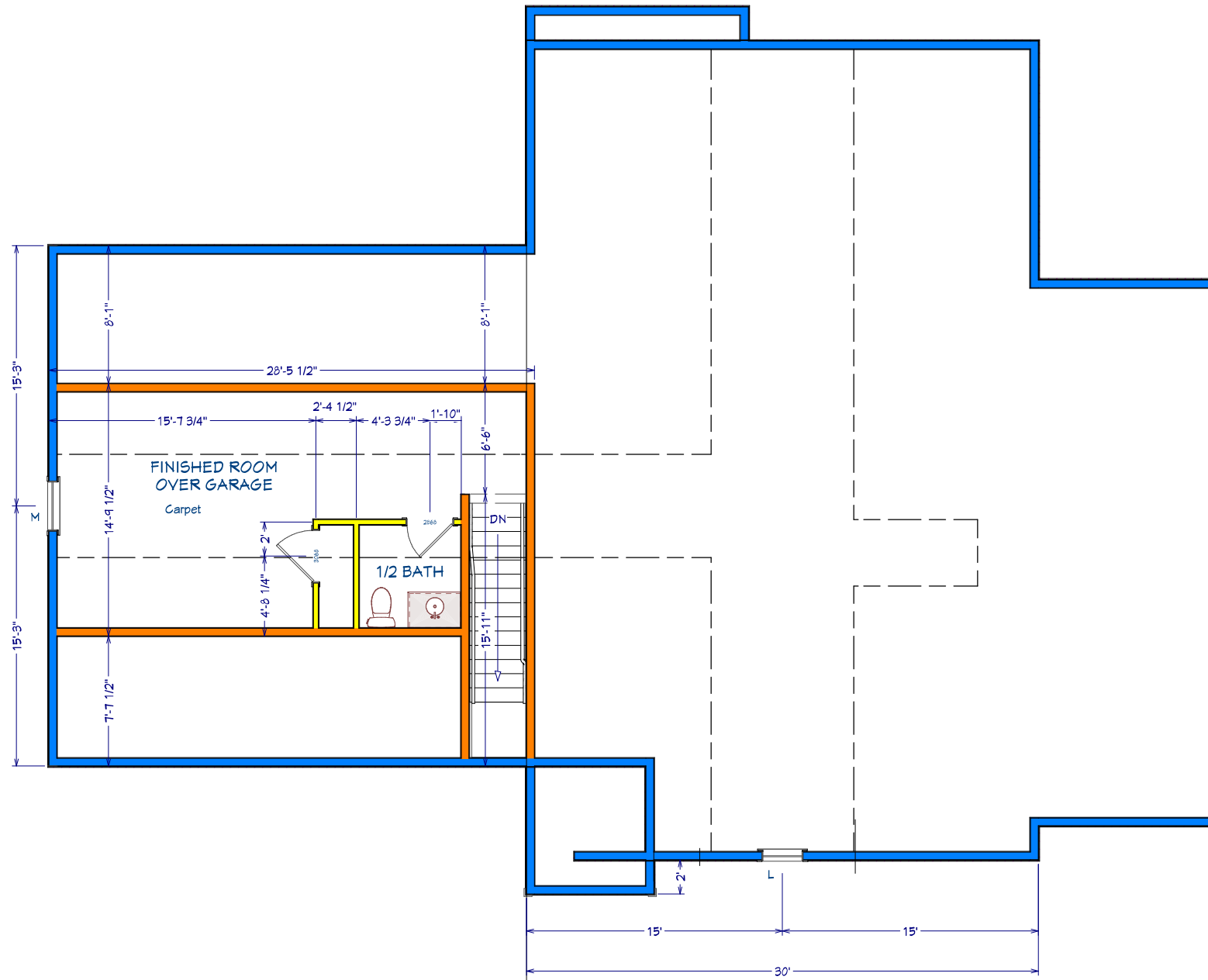

2nd Floor

NO.	DESCRIPTION	BY	DATE

SHEET TITLE:  
**Second Floor**

PROJECT DESCRIPTION:  
**HG-278 - Infill Site #1  
Plan-1336.04-Rev 2**

DRAWINGS PROVIDED BY:

DATE:

2/13/24

SCALE:

1/4"=1'-0"

SHEET:

**A-2**