



LIFESTYLE AT HIGHLAND GREEN

NEWS • PERSONALITIES • PERSPECTIVES

FALL/WINTER 2022

WHAT'S INSIDE:

Luxury Independent Living Apartments with Support if Needed

A Tribute to CREA Co-Founder John Rensenbrink

Latest CREA Events and Adventures

Meet the Neighbors: Patricia Vigilante & Robert Candela

Highland Green Home Option Updates

*Highland Green...
A welcoming community
melding luxury living
with the rugged beauty
of coastal Maine*



HIGHLAND GREEN™

7 Evergreen Circle, Topsham, Maine

1-866-854-1200 / 207-725-4549

HighlandGreenLifestyle.com

MEET THE NEIGHBORS

Patricia Vigilante and Robert Candela

Like so many who find themselves enchanted by Maine's raw beauty as well as the welcoming nature and adventurous spirit of the residents of Highland Green, Patricia Vigilante and Robert Candela were not immune to the charm of either. The couple spent the larger part of their lives commuting to work together from their suburban home to New York, which resulted in a very long day. Needless to say, they agree that they are extremely happy to be retired...and to be spending that retirement at Highland Green.

Patricia and Robert became aware of Highland Green a number of years ago when they came across the Cathance River hiking trails while they were doing some online research of where they might like to hike. Their drive through Highland Green on their way to the Cathance River Nature Preserve was actually what inspired them to move here!

With just a few short stints in the Midwest, Patricia has lived most of life in New Jersey. She spent her undergrad years at Columbia, earned her masters at NYU and then spent 40 years as a registered nurse, where her specialties were OBGYN and end of life hospice care.

Born and raised in Michigan, Robert moved in 1969 to take a position at the New York Times, where he served as photo editor for 39 years until his retirement in 2008. An avid reader of literary classics and history, Robert also enjoys playing guitar and singing in his free time; and his love of the outdoors made Maine a great choice for him.



Patricia, his wife of 25 years, has always joined him in his love of the outdoors. In fact, the couple vacationed in Deer Isle the first year they started dating and have been returning to hike through Acadia National Park just about every October since. More recently, their vacation stakes rose when their daughter and her family moved to Brunswick...and they came to love Maine even more.

This past spring, a neighbor made a generous offer to buy their Long Branch, New Jersey home. So, as Robert said, "We decided it was time to make our move, and we knew exactly where we wanted to go. July 1st, they moved to Highland Green.

Patricia and Robert are the second owners of one of the original Highland Green

Continued on page 4

THE ENCLAVE: *Take a Tour*

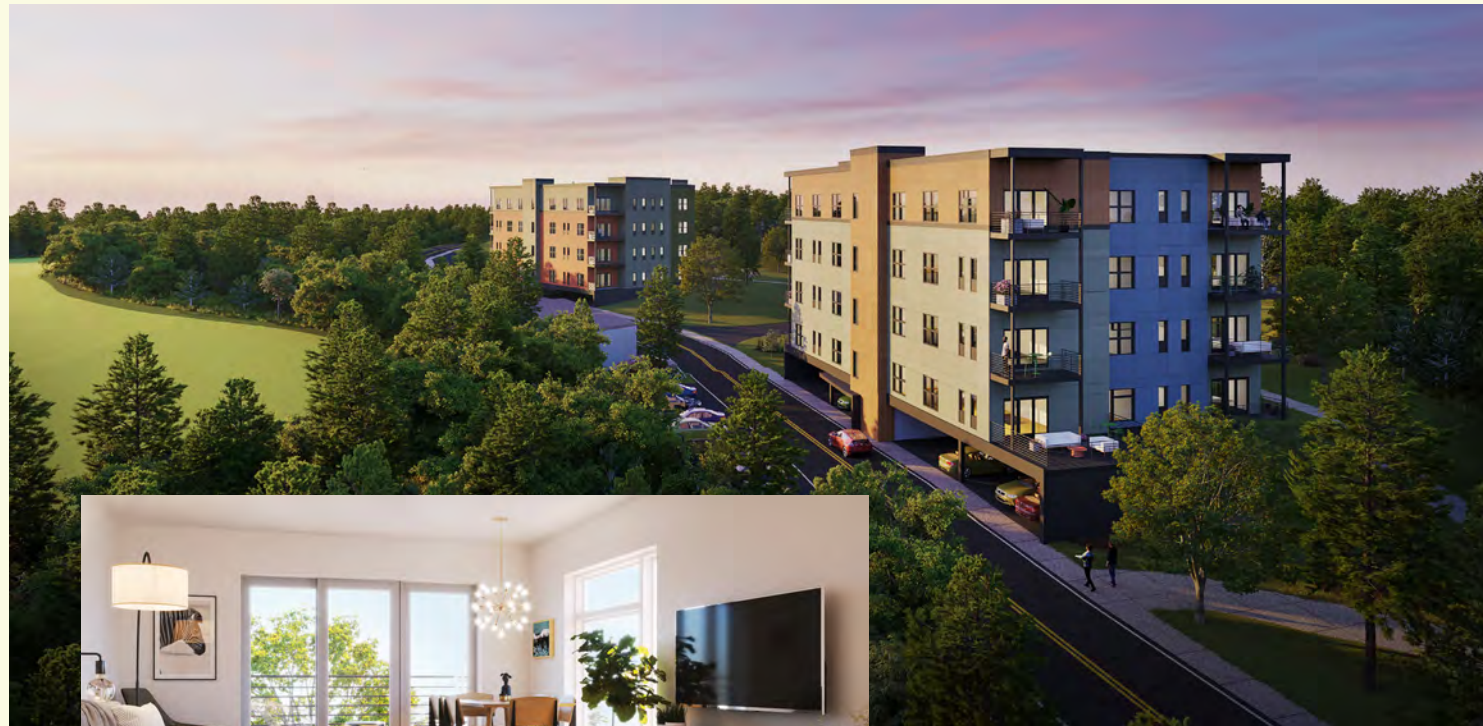

As with so many of the things we loved and longed for, the pandemic placed a temporary halt on The Enclave, but we are pleased to report that is no longer the case! Please join us on a delightful excursion through an apartment at The Enclave...

Before you even enter the spacious apartment; you'll notice The Enclave is located within walking distance of The Duck Pub & Restaurant and nicely situated near the 2nd hole at the golf course. So, you may want to pause to take in the scenic surroundings. By the way, when selecting your corner apartment, you can choose whether your balcony or patio offers a woodland view or a view of Highland Green's Scottish-style golf course.

One of the first things you will notice about the interior The Enclave is its high ceilings, which provide an airy expansive feel. Its sizeable windows allow for ample natural lighting and a bright, cheery feel. The Enclave apartment design is a contemporary, energy-efficient one with a sleek, modern appeal; and future residents will work with skilled design teams to customize items such as tile, counters, cabinets and backsplashes to meet their own particular tastes.



"The Enclave apartment design is a contemporary, energy-efficient one with a sleek, modern appeal"

Floorplans range from a 1,261 square-foot one-bedroom, two-bath model, to a three-bedroom, three-bath with 2,976 feet of living space, offering plenty of room to fit all of your beautiful furniture. All primary bedrooms include walk-in closets and a full bath. The living room is adorned with rich hardwood flooring and the state-of-the-art kitchen, located just off the dining area, is equipped with modern appliances. There is ample outdoor living space and a community room for dining and activities, as well as underground parking with elevator access.

The Enclave is a high-end independent living option with support services available on an as-needed basis. So whether you need a little assistance while you recover from a procedure or the flu or you simply require an annual check-in, a healthcare advocate or a just bit of healthcare advice, there is a registered nurse available to residents of The Enclave. Dining, transportation and housekeeping services are easily accessible too.

Highland Green is now accepting reservations for The Enclave. Call 207-725-4549 to make yours or learn more.

A Message from Highland Green CEO John Wasileski

Studies show that our environment can profoundly impact our lives. It can affect our mental and physical health by boosting our mood, reducing our stress, motivating us, giving a positive outlook on life and even lengthening life itself.

At Highland Green, residents are immersed within a beautiful, stimulating environment, from its welcoming nature; to its inspiring social, educational and cultural opportunities; its stylish homes; convenient access to the exciting offerings of the bustling cities nearby; and the rugged magnificence of coastal Maine.

We also consistently strive to enhance the environment for our residents, resulting in the constant evolution of Highland Green. The Enclave - a new construction plan including well-appointed, Independent Living, corner apartments offering unsurpassed views, as well as access to support services if needed - is testament to that effort.

We all endeavor to remain as independent as possible and hope that we never reach a time when we need a little help, but it's nice to know that it is there if it ever become necessary, providing our residents with the peace of mind that they need not be uprooted and can continue to enjoy the friendships they have forged, all the local offerings available, as well as the vibrant Highland Green lifestyle and the majestic environment within and surrounding Highland Green.



MEET THE NEIGHBORS Continued from page 1

homes. Their single level house, "with lots of trees and birds in the backyard," also came with a full, finished basement; a two-car garage; a completely enclosed, three-season porch which overlooks the woods and the golf course.

They found that they like the co-op concept of the community as well, mentioning that it's a pleasure not to have to worry about yard work, that the maintenance team at Highland Green takes wonderful care of the grounds and that they look forward to not worrying about snow removal.

Now that they live at Highland Green, they enjoy visits to the local farmers' market and, as Robert adds, "eating lobster and oysters, which are plentiful around here!" Patricia jokes that she is pretty sure that they may have tried every lobster shack between Freeport and Camden!

Aside from their partiality to area restaurants, since they moved to Highland Green, Patricia and Robert have expanded their hiking and exploration to the mountains and lakes of interior Maine...and now that they live in close proximity to their grandsons, Patricia and Robert attend as many of their school activities and sporting events as possible. They also enjoy walking along the golf course and the sidewalks throughout the community. As they did for years in New Jersey, they are volunteer drivers for Meals on Wheels, this

time with a regular route in Phippsburg. They also look forward to enjoying some live music and theater as soon as they get the chance.

Another thing that Patricia and Robert are so fond of at Highland Green is the fact that they don't have to go far to spend time with great friends. Robert says that they've made good friends here simply through chance meetings, and that the welcoming atmosphere at Highland Green is very refreshing.

Patricia is a knitter and has had the opportunity to attend a knitting session with a few Highland Green residents; and Robert has begun to play music with Highland Green residents who just happen to be a base player and a drummer. Patricia also participates in yoga class, which she attends at the Highland Green Community Center. She has also made friends there who she spends time with outside of yoga. Patricia and Robert also enjoy dinners with their Highland Green neighbors and swimming at the Highland Green pool with their grandsons.

"With our family and so much that we enjoy nearby, Highland Green is an excellent fit for us," said Robert.

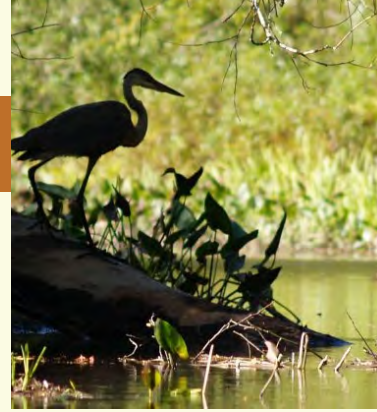

In Memorial...A Tribute to John Rensenbrink



John Rensenbrink (left) and John Wasileski co-founded the Cathance River Education Alliance in 2000 with the goal of deepening ecological-awareness through nature-based learning.

We are deeply saddened by the passing of CREA Co-founder John Rensenbrink. A true visionary dedicated to social, economic and ecological injustice, John was a formidable, yet soft-spoken political activist, a pioneer in education, an avid conservationist and renowned author.

Born of humble beginnings as one of seven children on a Minnesota farm, John earned a BA in both English and Philosophy. He received a Fulbright Scholarship to the University of Amsterdam and received his PhD in Political Science.

John taught philosophy and history at Bowdoin College before taking a United States Agency for International Development education advisory position to Kenya and Tanzania. He also served as a research professor in Poland during the Solidarity Movement, a topic on which his first book was based.

A promoter of healthy democracy, John was a primary founder of the Maine Green Party, John ran for United States Senate in the 80s. After his semi-retirement in 1989, he continued teaching at Bowdoin for several years and developed interdisciplinary seminars for black, women and environmental studies.

He also presented several papers at the University of Warsaw World Congress and served as its secretary, vice president and then president, organizing the 7th Congress at Hiroshima where he delivered an address advocating peace.

Locally, John helped found and served on the board of Merrymeeting Community Action, the first successfully funded anti-poverty program in Maine. He and his wife, Carla, helped create Topsham's Future, a citizen action group dedicated to balancing economy with preservation. He also co-founded the Cathance River Education Alliance, together with Highland Green's CEO John Wasileski.

Custom Homes and Quarry Cottages Going Fast!

We've experienced such a high demand for Highland Green custom homes and The Quarry cottages that we are adding a new section – Diamond Drive, which is located between The Quarry and the 5th hole; nestled along the woods with peekaboo views of golf course.

With five floorplans and virtually unlimited finish choices, The Quarry cottage standard options include 9' ceilings, 6' Andersen windows, sun room, granite countertops, tile, hardwood floors, as well as a basement, two-car garage and finished loft as available options. Each uniquely crafted, completely customizable Highland Green home provides a blank canvas for designs ranging from 1,400 to 3,500 square feet.

Whichever style you prefer, Diamond Drive homes are available on a first come, first served basis. Reserve your spot as soon as possible so you don't miss out on this limited opportunity.



Foundations are being poured on Jasper Drive for custom homes and Quarry Cottages.

HIGHLAND GREEN'S RENT WHILE YOU BUILD OPTION

Highland Green's Rent While You Build Program has been such a success that we are adding another lovely residence to our rental portfolio in an effort to accommodate the surge in requests to participate. The increased interest in this program is certainly understandable. Imagine your new home is being built at Highland Green and your home sells quickly. The Highland Green Rent While You Build option provides an interim step allowing new construction buyers to smoothly transition into Highland Green. For more information, contact our team of helpful, knowledgeable marketing professionals at 207-725-4549 to learn more. You can also visit highlandgreenlifestyle.com for home rental availability and specifications.



The cottage at 9 Sparrow Drive is currently available as part of the Rent While You Build Program.

CREA Corner

Cathance River Education Alliance (CREA) continues to astound, excite and enlighten through the wonders of nature...

Open to the public every day from dawn to dusk, the Cathance River Nature Preserve is a serene setting filled with lush greenery, a diverse collection of wildlife, cascading waterfalls, spring whitewater and trickling streams. It is also home to Cathance River Education Alliance (CREA), whose mission over the past 20 years has been to link people to the bountiful treasures of nature.

CREA's vibrant educational season aptly began with the Honors Biology students of Glenn Evans preparing for their fall research. October graced us with Eco-dilemmas: Are Solar Farms Good for Maine – a virtual panel discussion moderated by Fred Horsh, co-founder of Spark Applied Efficiency; and a Southern Midcoast Forest Play Group Autumn Leaf Exploration with a reading of "Leaf Man," creating autumn "leaf people" and playtime in the stump garden.

The Nature and Forest Therapy Walk, a relaxing, mindful, guided meditation walk led by Certified Forest Therapy Guide Phoebe, took place November 12th. Forest Play Group @ CREA: Nature Camouflage included a reading of *Twig* by Aura Parker. Then participants set out in search of camouflaged forest creatures and made their own masks. On November 22nd, CREA hosted Recycled Landscapes: Using Eco-Art to Advocate for the Environment – a virtual presentation by Eco-artist Mariah Reading, who was originally inspired by the rugged natural beauty of Maine's landscape.

On December 22nd, Forest Play Group is back with a reading of *Snow Birds* by Kristen Hall, participants will also be creating their own binoculars and winter bird watching. Stay tuned for details on more upcoming CREA events and adventures!



Ecology Center at Highland Green



Environmental Learning in Action

LIVING OPTIONS AT HIGHLAND GREEN

If you can't wait to indulge in the innovative, vibrant lifestyle at Highland Green, consider our move-in ready homes that are available now...

AVAILABLE NOW AT HIGHLAND GREEN

4 Tanager Drive – \$765,000

- 2,634 SF
- 2 BR, 3 Bath
- Finished walk-out basement
- Screened porch

This stylish and spacious residence is located a short stroll from the Community Center, offers two bedrooms and three bathrooms and includes a finished and east facing views from both the sun porch and the backyard patio.

As you enter the home, you'll walk into a spacious entryway adjacent to a formal dining room with a hardwood floor and sunny bay window. Around the corner to the left is the guestroom and full bathroom with shower/tub combination. The hall from the dining room leads to an open kitchen, with a small eat-in area as well as open access to a spacious living room.

The living room features floor-to-ceiling custom built-ins surrounding the natural gas fireplace. Off the kitchen is the sunny screened-in sun porch with mature landscaping and granite staircase leading to the backyard.



The main floor also features the primary bedroom suite with walk-in closet and full bath. There is a laundry/mud-room area leading to the garage.

In the finished basement, there is a great room with east facing windows and sliding glass doors to the patio. This finished basement area has ample space to be used as a game room, craft space, library or guest bedroom. There is a full bathroom in the basement and plenty of basement storage. The back paver patio has a custom rock wall/bench surrounding the perimeter of the space with flowering trees and hillside views.

This home has a one-car garage and a central air conditioning/forced hot air heating system. All Highland Green homes enjoy underground utilities: Public Water



and Sewer, Natural Gas, Electric, Centrally Monitored Smoke and Low Temperature Detection.

Each Highland Green home has existing equity in Highland Green's strong community finances: Common Reserves, Co-Op Reserves, and Reserve Investments. Community Budget, Financials and Reserve Study Review available upon request.

To learn more, call Highland Green at 1-866-854-1200 today!

THE ENCLAVE AT HIGHLAND GREEN

The Enclave is an entirely new concept in apartment-style retirement living - at the corner of luxury and open design. Offering contemporary luxury, energy-efficiency and maintenance-free living, The Enclave is also seamlessly integrated into the incredible lifestyle at Highland Green. Residents of The Enclave enjoy the benefit of supportive services including transportation, wellness program, interior and exterior maintenance, dining services, and housekeeping, among others.



QUARRY COTTAGES AT HIGHLAND GREEN

Cottages at the Quarry are distinctive, exquisitely built cottage homes with quality craftsmanship and stunning finishes, yet priced to scale. Our three customizable floor plans can be upgraded with features such as granite countertops, stainless appliances and hardwood floors as well as two-car garages and solar energy. Of course, each quarry home is also designed and constructed with the same painstaking care and attention to detail as all of our Highland Green residences, regardless of size, style or price range.



CUSTOM HOMES AT HIGHLAND GREEN

Custom Homes at Highland Green are a blank canvas ripe for filling with color, warmth, light and life...all to create a paradise of your own design. While they last, select lots are now available for custom building on elevated home sites abutting the picturesque Cathance River Preserve here at Highland Green. But don't delay. To make your move before 2023, you need to set your sights on a site now. Having designed and built more than 200 homes from the ground up, we have a deep inventory of existing plans that you can either replicate or modify.



Custom Homes at HG are a paradise of your own design.



Assisted Living and Memory Care will be a new addition to the Highland Green campus, providing seamless access to a valuable extension of support services.

Put Your Move in Motion. Call 1-866-854-1200 today to plan your future.



HIGHLAND GREEN™

7 Evergreen Circle
Topsham, Maine 04086

highlandgreenlifestyle.com

*See inside: Luxury Apartments with
Support Services as Needed.*

Embrace the Beauty of Life at Highland Green



Highland Green is an exceptional 55+ community nestled within hundreds of pristine acres. It is a place where you will discover nature's bold beauty, stimulating interaction, and an unparalleled welcoming spirit...all of which are also just a convenient drive to culturally rich villages, towns and cities and all they offer.



For more information, call **1-866-854-1200** or **207-725-4549**, visit highlandgreenlifestyle.com or like us on Facebook.

